

## SPIKA MS410 REMOTE THREE PHASE 400 V / 50 Hz

### MODULAR ICE CUBE MACHINE

#### FEATURES CARATTERISTICHE

- ▶ **PRODUCES FULL DICE ICE CUBES OR HALF DICE ICE CUBES**  
PRODUCE CUBETTI A DADO E A MEZZO DADO
- ▶ **HIGH EFFICIENT EVAPORATOR**  
EVAPORATORE AD ALTA EFFICIENZA
- ▶ **SMART WATER DISTRIBUTOR THAT IMPROVES DROP-OFF EFFICIENCY**  
DISTRIBUTORE INTELLIGENTE DI ACQUA CHE MIGLIORA L'EFFICIENZA DURANTE LA RIMOZIONE
- ▶ **EASY ACCESS BY REMOVING THE PANELS WITH A SINGLE SCREWDRIVER**  
ACCESSO FACILE MEDIANTE LA RIMOZIONE DEI PANNELLI CON UN SOLO CACCIAVITE
- ▶ **SMART ELECTRONIC BOARD CONTROLS EVERY PARAMETER IN THE MACHINE AND SHOWS THE DIAGNOSIS OF POSSIBLE INCIDENCES**  
PLACCA ELETTRONICA INTELLIGENTE CHE CONTROLLA I PARAMETRI DELLA MACCHINA E INDICA LA DIAGNOSI DI EVENTUALI PROBLEMI
- ▶ **ENERGY STAR, LOW POWER CONSUMPTION CERTIFICATION**  
ENERGY STAR, CERTIFICATO DI BASSO CONSUMO ELETTRICO
- ▶ **HIGH RESISTANCE EXTERNAL FRAME IN AISI 304 STAINLESS STEEL**  
STRUTTURA AD ALTA RESISTENZA IN ACCIAIO INOSSIDABILE AISI 304

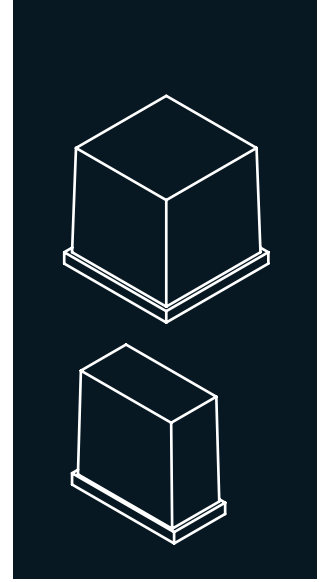

	24 H	10°C	10°C	21°C	15°C	(Kg)	(mm)	(mm)	<b>SPIKA HALF DICE 6gr</b> 23 mm (W) x 11 mm (D) x 26 mm (H) 0.9" (W) x 0.4" (D) x 1" (H) Average dimensions Dimensioni medie
SPIKA MS410R						424	Width 760 Depth 620 Height 762	Width 836 Depth 635 Height 874	<b>SPIKA FULL DICE 12gr</b> 26 mm (W) x 23 mm (D) x 26 mm (H) 1" (W) x 0.9" (D) x 1" (H) Average dimensions Dimensioni medie
RC10S	-	-	-	-	-	-	Width 425 Depth 746 Height 566	Width 510 Depth 770 Height 700	

#### ACCESSORIES ACCESSORIOS

##### INCLUDED



**WATER INLET FILTER GASKET**  
GIUNTURA DEL FILTRO DI INGRESSO DELL'ACQUA



**WATER INLET HOSE**  
TUBO INGRESSO DELL'ACQUA



**WATER OUTLET HOSE**  
TUBO DI SCARICO

##### NOT INCLUDED (OPTIONAL)



**ANTI-LIMESCALE FILTER**  
FILTRO ANTICALCARE



**PARTICLE FILTER**  
FILTRO ANTIPARTICOLATO



**ANTI-LIMESCALE + ANTI-CHLORINE FILTER CS101**  
FILTRO ANTICALCARE + ANTICLORO CS101

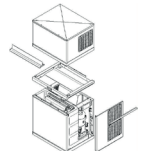

**STACKING KIT**  
KIT IMPILAMENTO

#### RECOMMENDED BINS SERBATOIO RACCOMANDATI

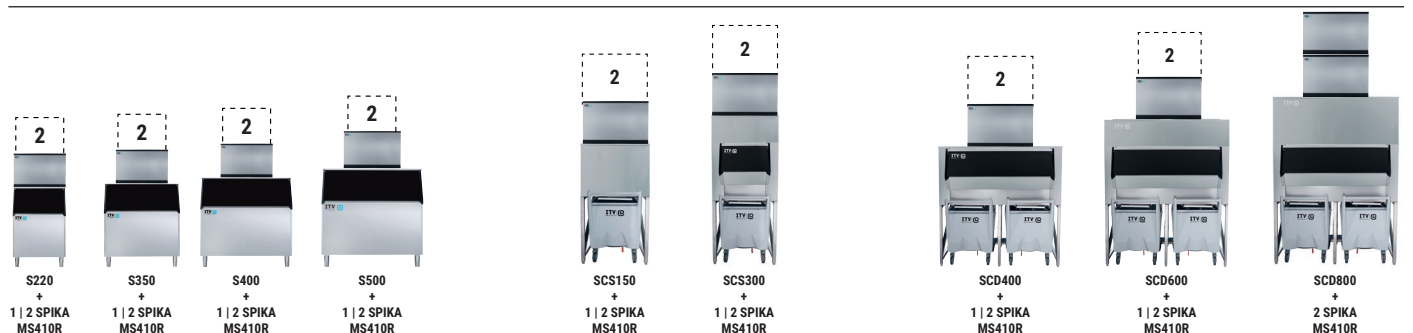

SPIKA MS410 REMOTE

RIGHT SIDE VIEW  
VISTA LATERALE DESTRA

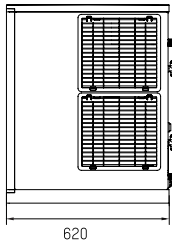

FRONTAL VIEW  
VISTA FRONTALE

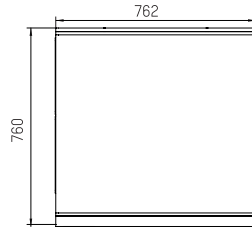

REAR VIEW  
VISTA POSTERIORE

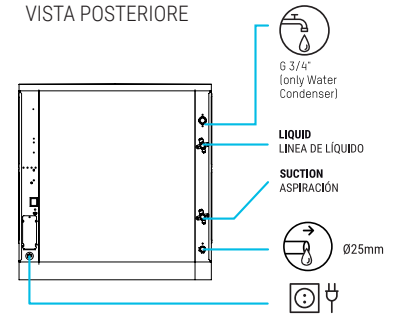

CENTRAL CROSS SECTION  
VIEW OF THE BASE  
VISTA DELLA BASE DALLA  
ZONA CENTRALE

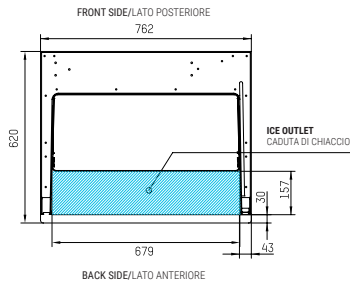

RC10S

RIGHT SIDE VIEW  
VISTA LATERALE DESTRA

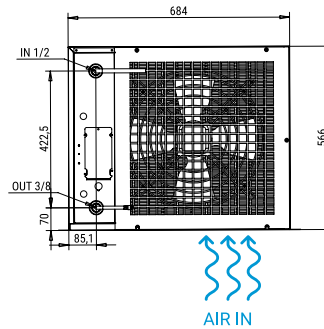

TOP VIEW  
VISTA IN PIANTA

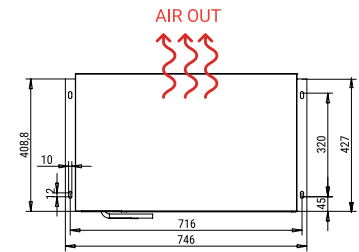

\* All measurements in mm.  
\* Tutte le misure in mm.

OPERATING CONDITIONS CONDIZIONI PER IL FUNZIONAMENTO

PRODUCTION 50Hz PRODUZIONE 50 Hz

±10% V

10°C/43°C

5°C/38°C

1 bar/6 bar

400/800 Ice cubes/cycle

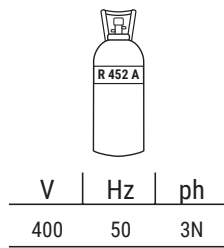

°C °F	SPIKA MS410 R			
	10° 50°	15° 60°	21° 70°	30° 86°
10° 50°	424	412	403	379
21° 68°	413	405	394	379
32° 90°	395	366	335	318
43° 109°	331	290	265	249

MODELS  
MODELLI

SPIKA MS410R

RC10S

	+C° -C°	ASHRAE CONDITIONS CONDIZIONI ASHRAE (W) (BTU/h)	(W) 43°C	(n.) (mm²)	FUSE	100 Kg (Kwh)	(l/h) FULL   HALF	HEAT REJECTED (W) (BTU/h)	(Kg)	(Kg)	(m³)
SPIKA MS410R		11.185 38.185	1.540	3 2,5	15	9,9	17 17	3.505 11.960	105	110	0,53
RC10S		- -	200	2 1,5	10	-	- -	- -	40	50	0,27



ITV ICE MAKERS, S.L.  
POL. IND. SECTOR 13, AVDA. DELS HOSTALERS, 2  
46394 RIBARROJA DE TURIA, VALENCIA, SPAIN  
PHONE: +34 96 166 75 75 | FAX: +34 96 166 81 00  
info@itv.es | www.itv.es



SERVICE  
SERVIZIO ASSISTENZA TECNICA  
service@itv.es  
Skype: ITV.Service  
+34 961 667 639  
8:00AM | 7:00PM



Subject to certain limitations  
and exclusions. Only spare parts.  
Soggetta a limitazioni e revoca. Solo  
parti di ricambio.

